



2 Saffron Court, High Street

Barwell, Leicester, LE9 8BZ

Offers In The Region Of £84,950



A modern ground floor flat, having the benefit of modern night storage heating, PVCu double glazing, fitted kitchen, shower room, double bedroom, communal gardens and secure gated parking. The property is ideally located within the hub of Barwell centre, close to all local amenities, including local shops, schools and regular public transport services.

Conveniently located for commuting to all major road links, such as the A5, M69, M6 and M1.

MUST BE VIEWED. 55 years +

NO CHAIN.



Spacious lounge 13'7" 11'10" (4.16 3.62)
PVCu double glazed door, modern night storage heater and PVCu double glazed door.

Modern kitchen (rear) 8'2" x 6'0" (2.49 x 1.85)
Stainless steel sink unit, range of base and wall units (5 base and 4 wall), associated work surfaces, split level ceramic hob, electric (fan assisted) oven, extractor, ceramic tiling and modern night storage heater.

Double bedroom (front) 10'9" x 10'6" (3.29 x 3.21)
PVCu double glazed window and modern night storage heater.

Hall 7'1" x 6'10" (2.17 x 2.09)
Fitted cupboard.

Modern shower (rear) 7'6" x 7'1" (2.31 x 2.17)
Suite in white, fitted shower cubicle with mixer shower, wash hand basin vanity unit, low flush wc with concealed cistern, ceramic tiling, airing cupboard and extractor fan.

Outside
Communal gardens.
Secure parking with electric gates.

Area Map



Floor Plans

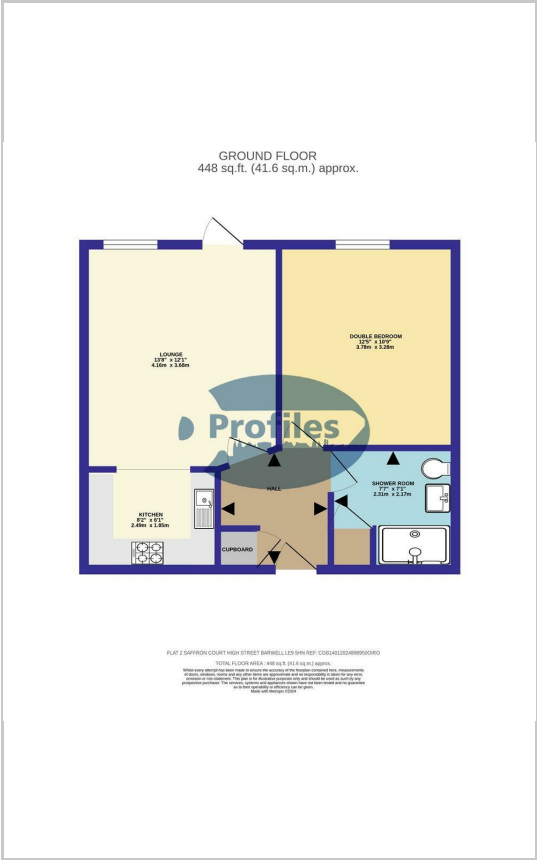

Energy Efficiency Graph

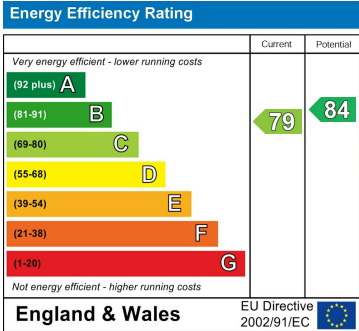

These particulars, whilst believed to be accurate are set out as a general outline only for guidance and do not constitute any part of an offer or contract. Intending purchasers should not rely on them as statements of representation of fact, but must satisfy themselves by inspection or otherwise as to their accuracy. No person in this firms employment has the authority to make or give any representation or warranty in respect of the property.